

SERVICE MANUAL

BE-3D CHASSIS

MODEL	COMMANDER	DEST.	CHASSIS NO.	MODEL	COMMANDER	DEST.	CHASSIS NO.
KV-29F1A	RM-862	Italian	SCC-K05B-A	KV-29F1K	RM-862	OIRT	SCC-K08B-A
KV-29F1B	RM-862	French	SCC-K01B-A	KV-29F1R	RM-862	OIRT	SCC-K08C-A
KV-29F1D	RM-862	AEP	SCC-K07B-A	KV-29F1U	RM-862	UK	SCC-K04B-A
KV-29F1E	RM-862	AEP	SCC-K06B-A				

SUPPLEMENT - 2

SUBJECT : CHANGE OF PART NUMBERS

File this supplement with the service manual

INTRODUCTION :Change of Part Numbers for models with Serial Numbers beginning at 600001

- **SECTION 5 DIAGRAMS**

(D Board, Page 45) See page 2

(A Board, Page 50) See page 12

(C Board, Page 60) See page 12

- **SECTION 6 EXPLODED VIEWS**

6-1. CHASSIS (Page 71) See page 15

6-2. PICTURE TUBE (Page 72) ... See page 16

- **SECTION 7 ELECTRICAL PARTS LIST** (Page 73) See page 17



TRINITRON® COLOR TV
SONY®

HV OUT,PIN OUT,POWER SUPPLY,CONTROL
SW, AUDIO IN Y-CHROMA IN,HEADPHONE IN,
SIRCS RECEIVE, INDICATION

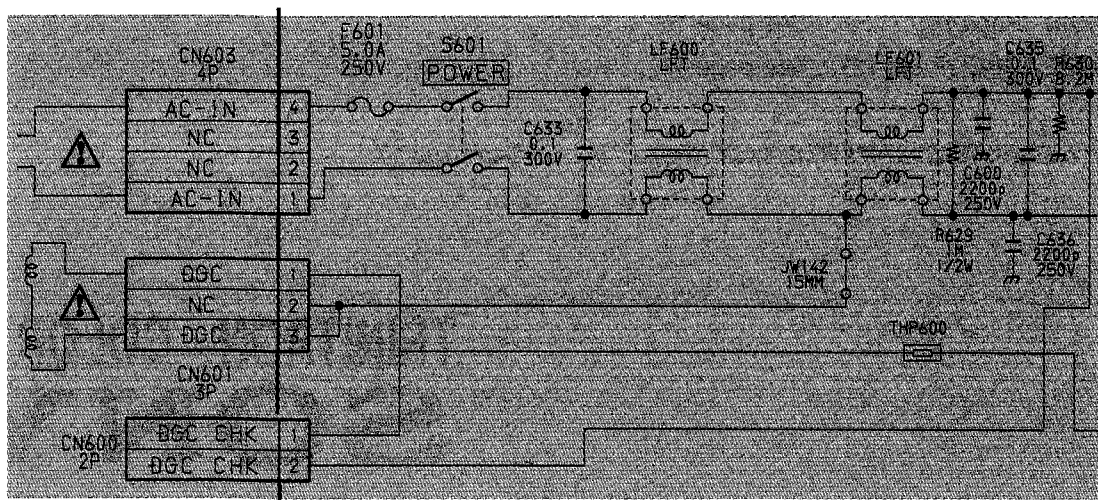
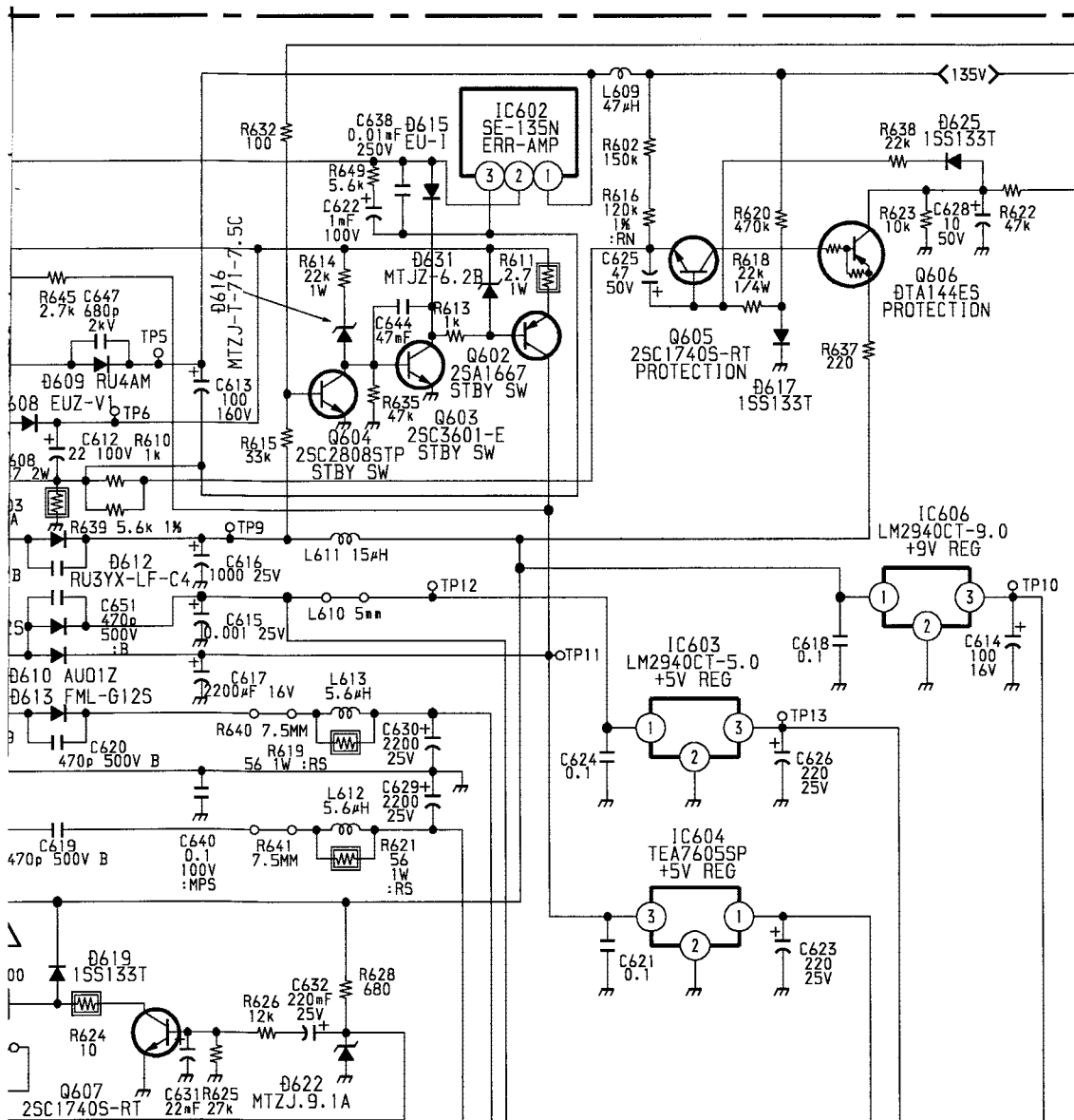

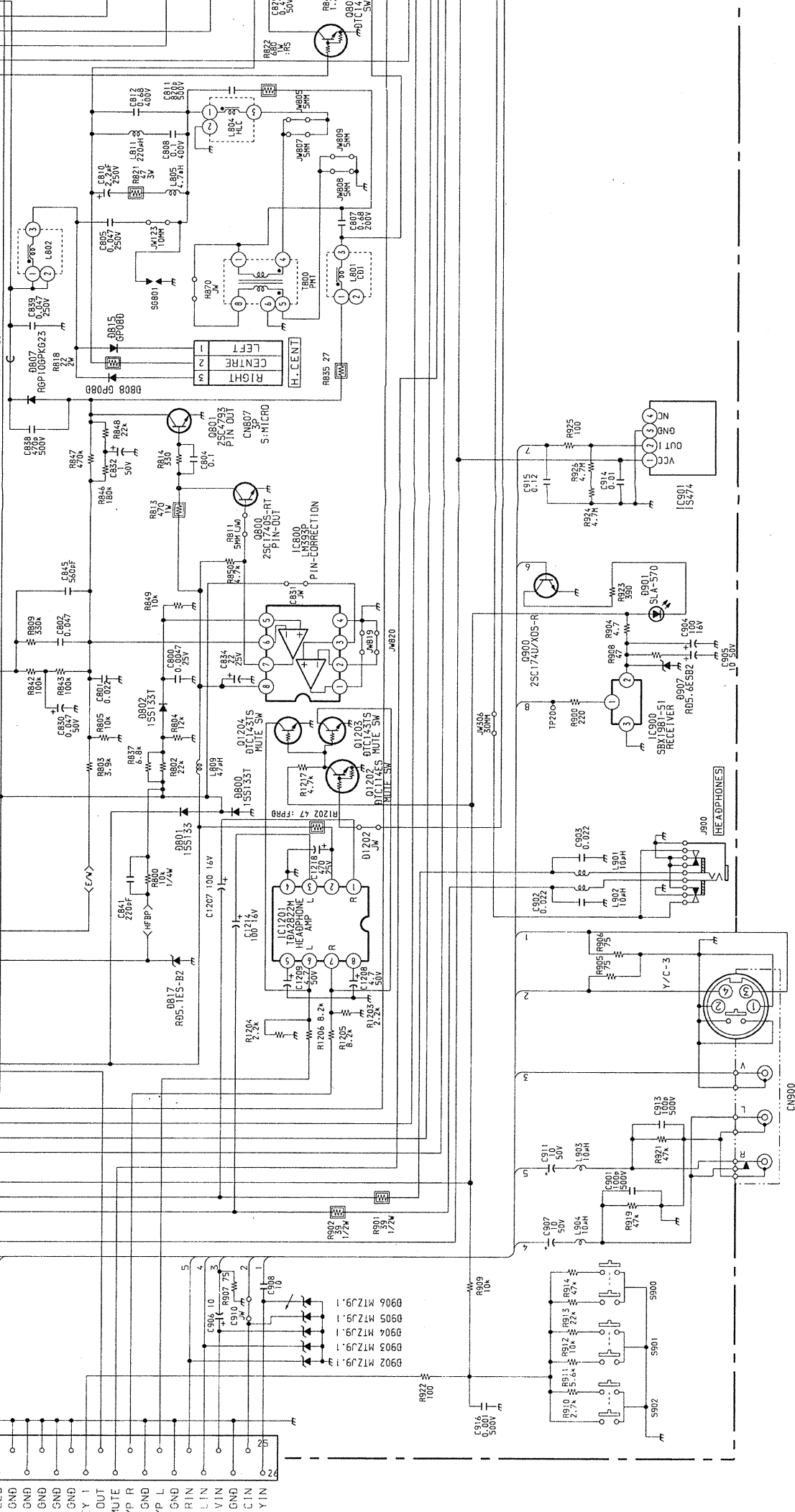

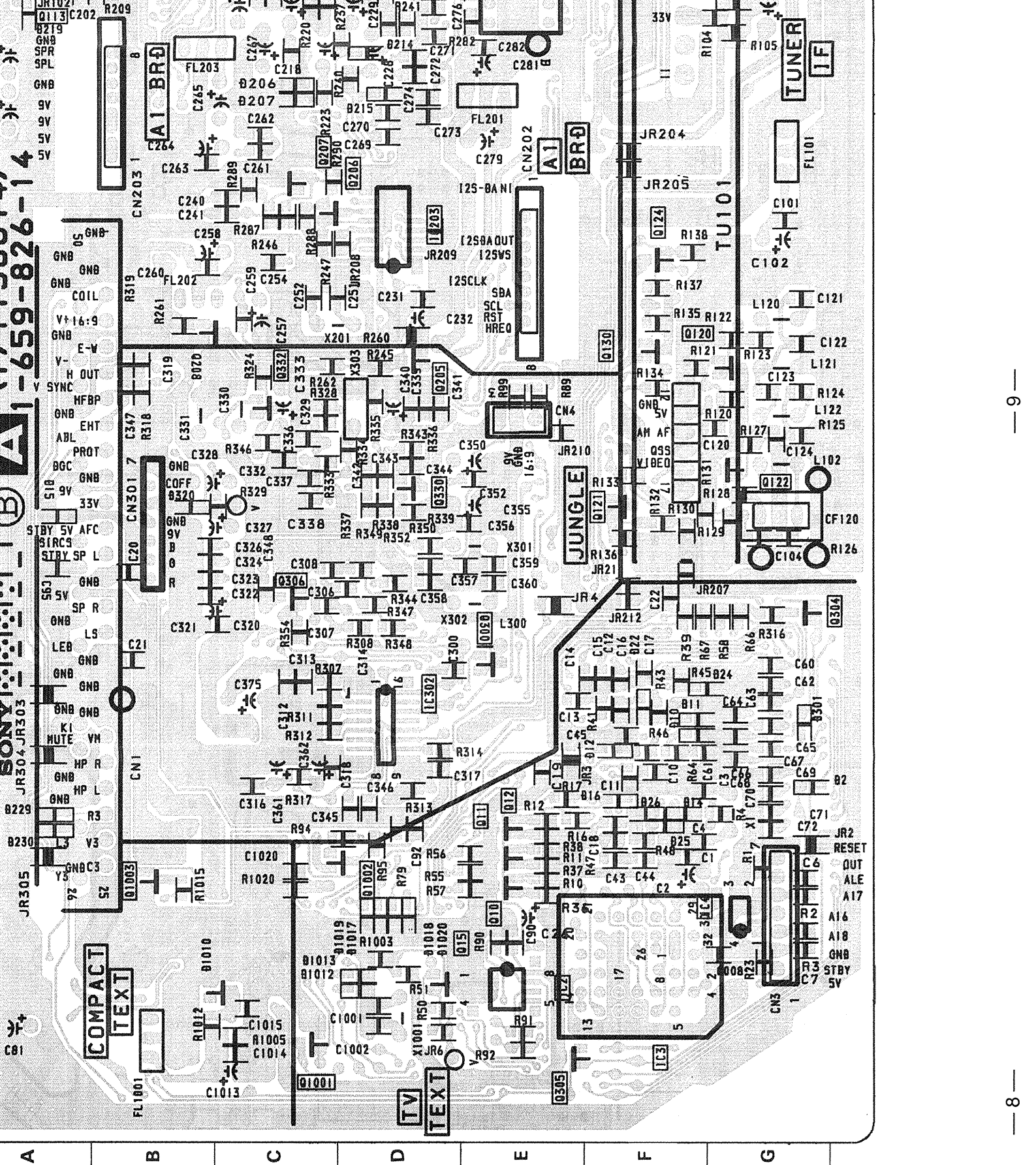

A BOARD * MARK

	29F1A	29F1B	29F1D	29F1E	29F1K	29F1R	29F1U
C321	0.01MF	0.01MF	0.01MF	0.01MF	-	-	0.01MF
C330	0.1MF	0.1MF	0.1MF	0.1MF	-	-	0.1MF
C370	-	2.2MF	2.2MF	2.2MF	2.2MF	2.2MF	-
C372	-	0.1MF	0.1MF	0.1MF	-	-	-
C373	-	0.1MF	0.1MF	0.1MF	-	-	-
D370	-	BAS216	BAS216	BAS216	BAS216	BAS216	-
IC301	CXA2000Q	CXA2000Q	CXA2000Q	CXA2000Q	-	-	CXA2000Q
IC303	-	TDA8395T	TDA8395T	TDA8395T	TDA8395T	-	-
Q113	2SA1037K	2SA1037K	2SA1037K	2SA1037K	-	-	2SA1037K
Q114	2SA1037K	2SA1037K	2SA1037K	2SA1037K	-	-	2SA1037K
R116	4.7K	4.7K	4.7K	4.7K	-	-	4.7K
R117	2K	2.2K	2K	2K	2K	2K	2.2K
R118	8.2K	8.2K	8.2K	8.2K	-	-	8.2K
R119	220	220	220	220	-	-	220
R283	10K	10K	10K	10K	-	-	10K
R286	10K	10K	10K	10K	-	-	10K

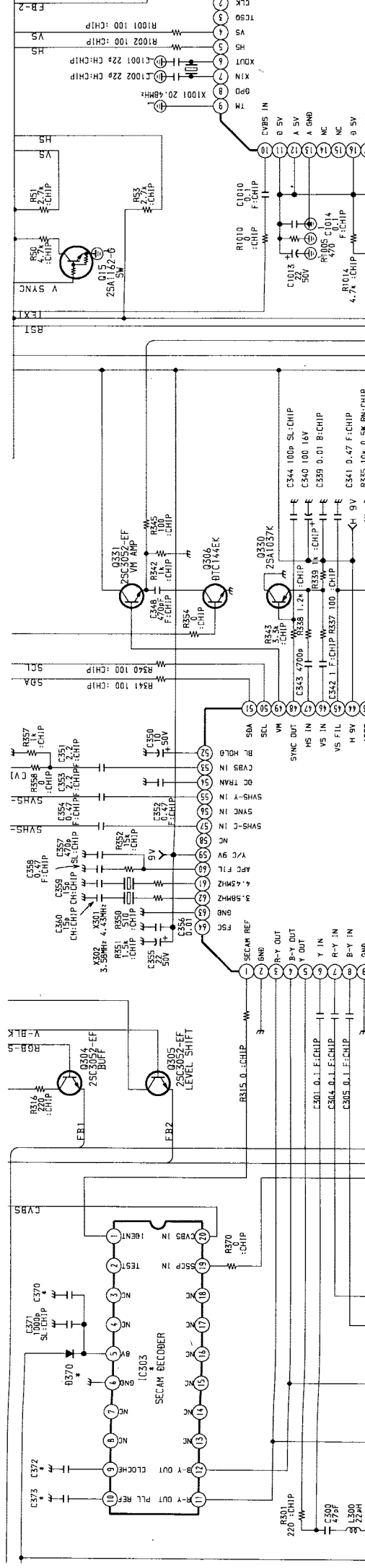
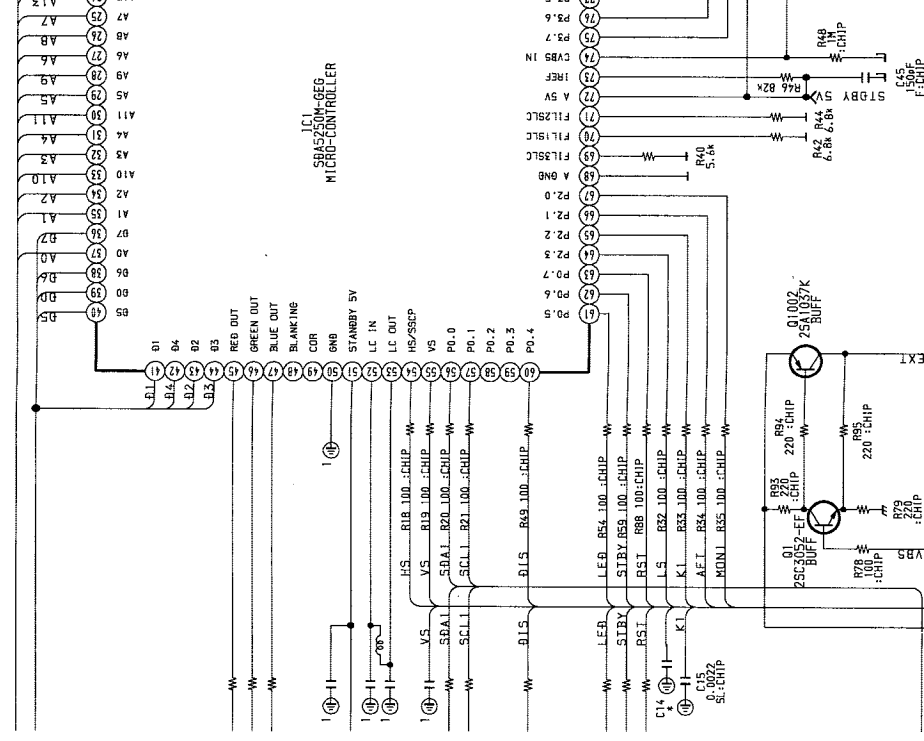

6-1. CHASSIS

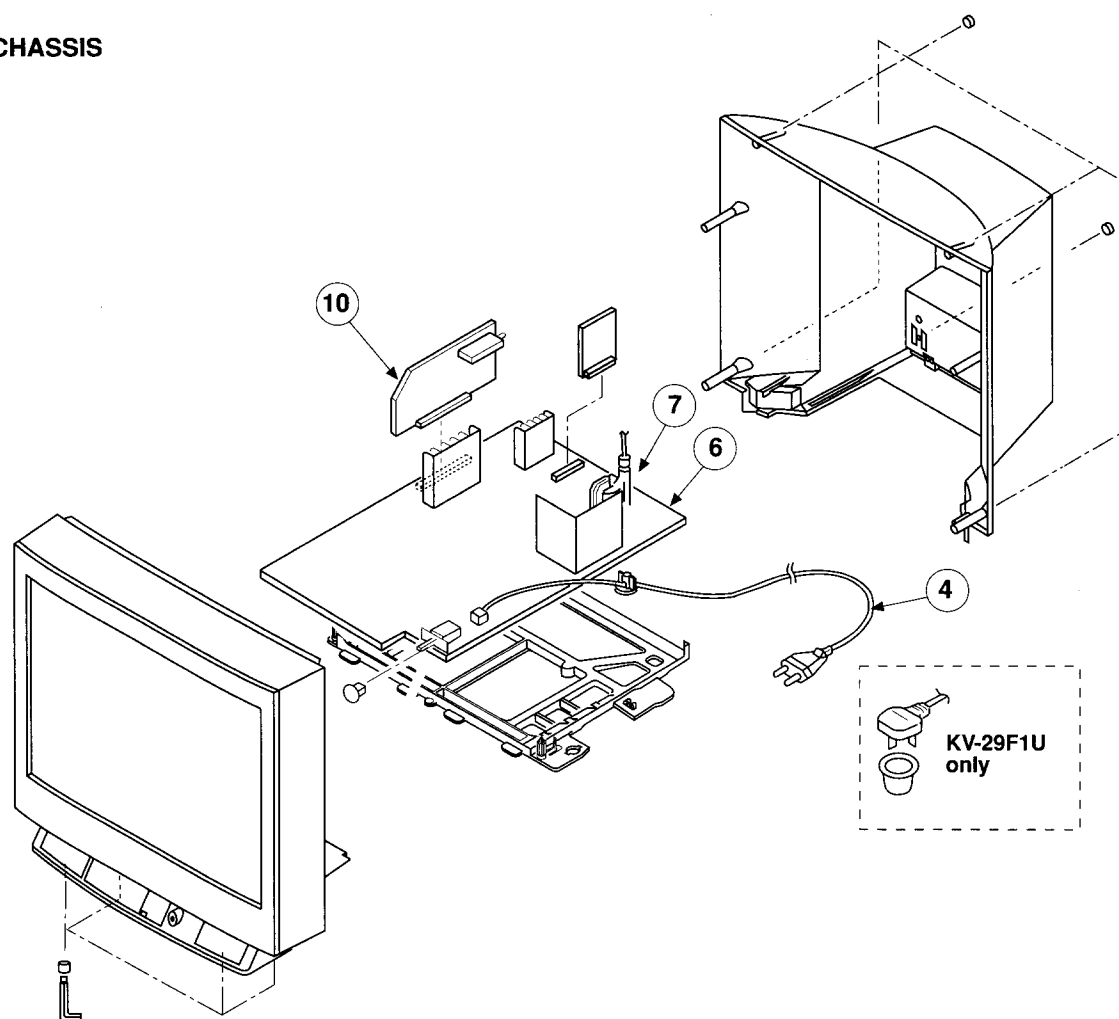

6-2. PICTURE TUBE

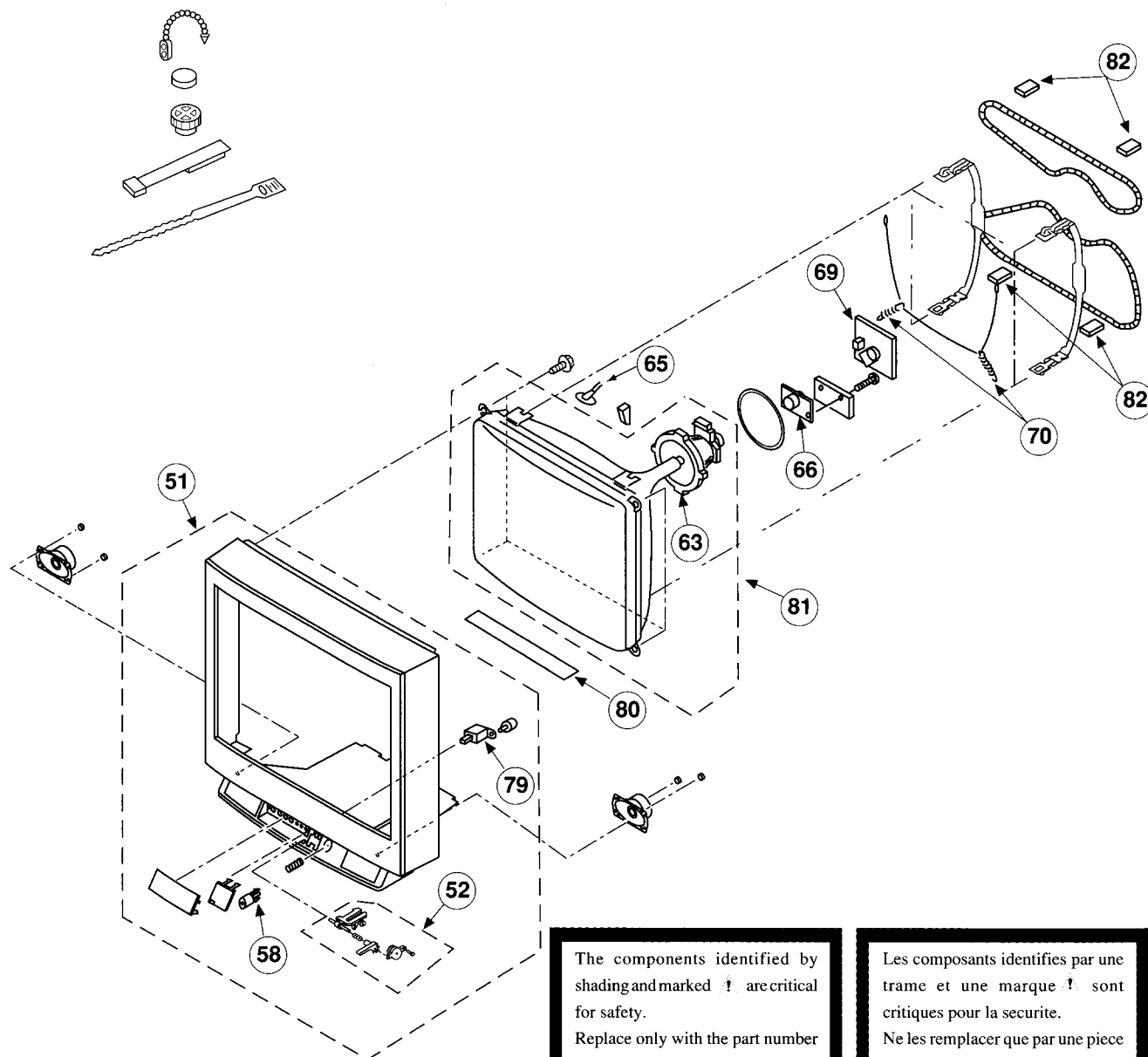

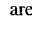
The components identified by shading and marked  are critical for safety. Replace only with the part number specified.

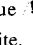
Les composants identifiés par une trame et une marque  sont critiques pour la sécurité. Ne les remplacer que par une pièce portant le numéro spécifié.